

**Teknik Katalog**  
Technical Catalogue

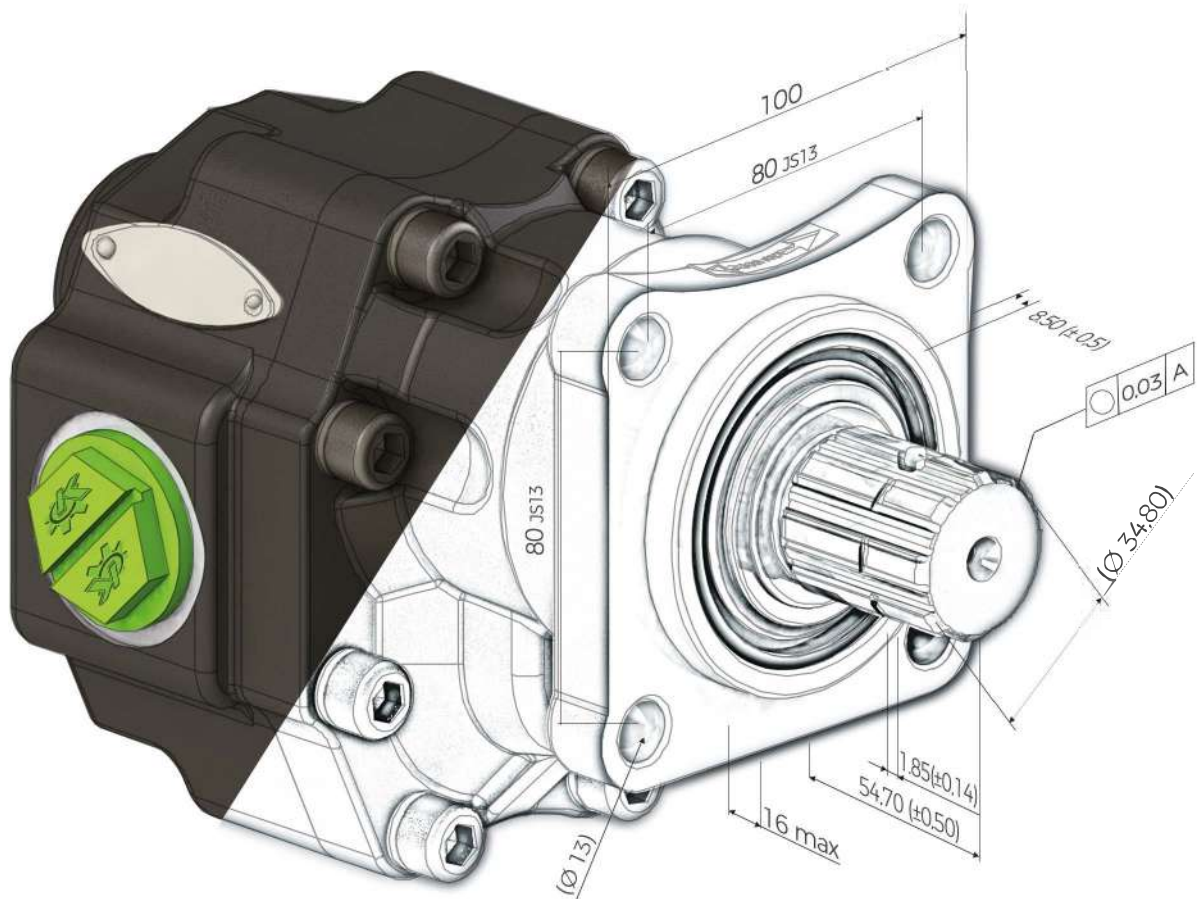

[www.kozmaksan.net](http://www.kozmaksan.net)



**PDCD**

**25**

**045**

**01**

**3**

**3**

Pompa Türü  
Pump Type

Pompa Tipi  
Pump Type

Pompa Debisi  
Displacement

Mil Tipi  
Shaft Type

Kapak Bağlantı Deliği  
Mounting Holes

Dönüş Yönü  
Rotation

## Pompanın Türü / Pump Type

- PDCD : Çift Dönüştü Dişli Pompa / **Bi Rotatonal Gear Pumps**  
PDTDK : K Serisi Dişli Pompa / **K Series Gear Pumps**  
PDTD : Tek Dönüştü Dişli Pompa / **Single Rotatonal Gear Pumps**  
PDTDT : Tandem Dişli Pompa / **Tandem Gear Pumps**  
PED : Pistonlu Pompa / **Piston Pumps**  
PEX7 : Eksenel Pompa / **Bent Axis Pump**

## Pompanın Tipi / Pump Type

- 25 : 25 Serisi Dişli Pompa / **25 Series Gear Pumps**  
30 : 30 Serisi Dişli Pompa / **30 Series Gear Pumps**  
35 : 35 Serisi Dişli Pompa / **35 Series Gear Pumps**  
40 : 40 Serisi Dişli Pompa / **40 Series Gear Pumps**  
09 : 9 Pistonlu Pompa / **9 Piston Pumps**  
06 : 6 Pistonlu Pompa / **6 Piston Pumps**  
52 : 7 Pistonlu Pompa / **7 Bent Axis Piston Pump**

## Pompanın Debisi / Displacement

- 015 - 025 - 035 - 045 : 15 - 25 -35 -45 litre / **15 - 25 - 35 - 45 liters**  
043 - 051 - 055 - 065 - 082 : 43 - 51 - 55 - 65 - 82 litre / **43 - 51 - 55 - 65 - 82 liters**  
075 - 085 - 090 - 105 - 125 : 75 - 85 - 90 - 105 - 125 litre / **75 - 85 - 90 - 105 - 125 liters**  
063 - 073 - 087 - 109 - 133 - 151 : 63 - 73 - 87 - 109 - 133 - 151 litre / **63 - 73 - 87 - 109 - 133 - 151 litres**  
050 - 060 - 080 : 50 - 60 - 80 litre / **50 - 60 - 80 litres**

## Mil / Shaft

- 00 : Milsiz / **Without Shaft**  
01 : 8 Frezeli Mil / **8 Traillet Shaft**  
02 : 6 Frezeli Mil / **6 Traillet Shaft**  
03 : Kama Düz / **Wedge Straight**  
04 : Kama Konik / **Tapered Wedge**

## Kapak Bağlantı Deliği / Mounting Holes

- : UNI  
3 : ISO  
5 : K Serisi / **K Series**

## Dönüş Yönü / Rotation

- : Sağ Dönüştü / **Clockwise (CW)**  
2 : Sol Dönüştü / **Anticlockwise (CCW)**  
3 : Çift Dönüştü / **Bi-Rotatonal**



# 25 Grubu Çift Dönüslü Dişli Pompa 25 Group Bi-Rotational Gear Pumps



## Pompa Tipi Okuma Diyagramı | Type Reading Diagram

<b>PDCD</b>	-	<b>25</b>	-	<b>015</b>	-	<b>01</b>	-	<b>3</b>	-	<b>1</b>
Çift Dönüslü Dişli Pompa Bi Rotational Gear Pumps		25 Serisi Dişli Pompa 25 Series Gear Pumps		Pompa Debişi Displacement		Mil Tipi Shaft Type DIN 5462 ISO		Bağlantı Tipi Mounting holes		Dönüş Yönü Rotation

## Teknik Çizim | Technical Drawing

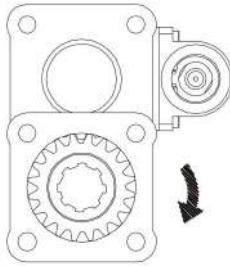

PTO Mili saat yönünde (SAĞ)  
The PTO shaft is CW rotating

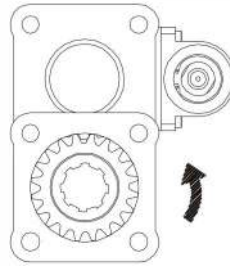

PTO Mili saatin tersi yönünde (SOL)  
The PTO shaft is CCW rotating

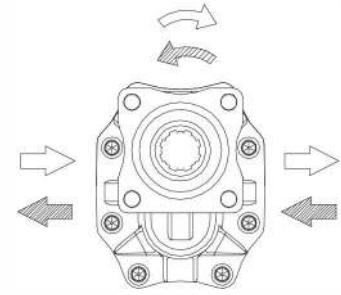

çift yönlü dönüş  
Reversible Rotational

Giriş-Çıkış Rakor yerlerini  
değiştirerek yönünü değiştirebilirsiniz  
You Can Change The Directional Of The Pump  
By Changing The Inlet And Outlet Fitting

## Basınç Tanımı | Pressure Definiton

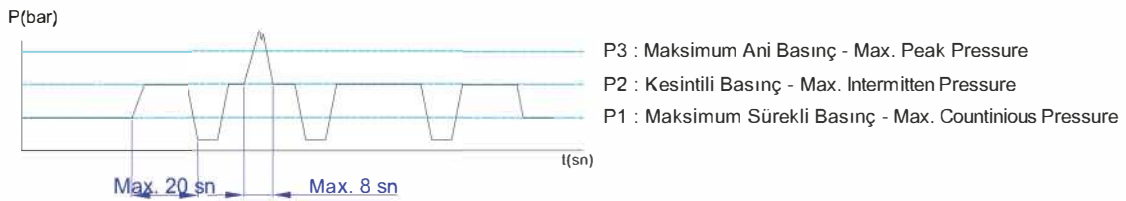

Pompa Tipi Pump Type	Debi Displacement	Max. Sürekli Hız Max. Speed at Continuous Press.	Maksimum Kesik Hız Max. Speed at Intermittent Press.(nmax)	Min Kesik Hız Min. Speed at Intermittent Press.	Max Sürekli Basınç Max. Continuous Pressure (P <sub>nom</sub> )	Max. Kesik Basınç Max. Intermittent Pressure (P <sub>max</sub> )	Max. PİK Basınç Max. Peak Pressure (P <sub>max</sub> )
	lt/min	n (min <sup>-1</sup> ) (≤ P1)	n (min <sup>-1</sup> ) (P ≤ 30 bar)	n (min <sup>-1</sup> )	bar	bar	bar
15 lt	15	1900	2500	400	240	270	290
25 lt	25	1900	2500	400	210	240	250
35 lt	35	1700	2300	300	180	200	210
45 lt	45	1700	2300	300	170	190	200





# 25 Grubu Çift Dönürlü Dişli Pompa 25 Group Bi-Rotational Gear Pumps

15 LT

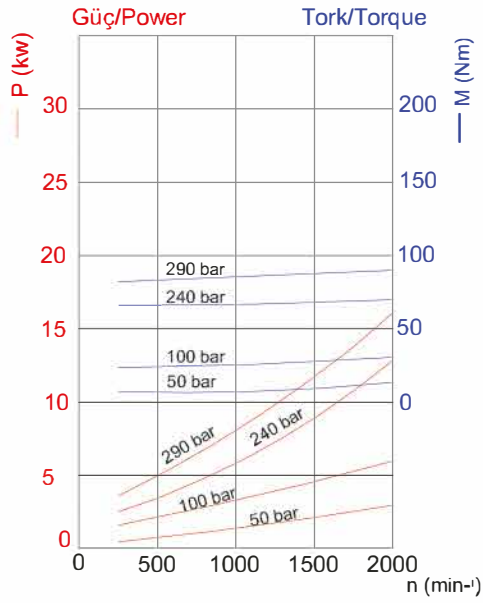

25 LT

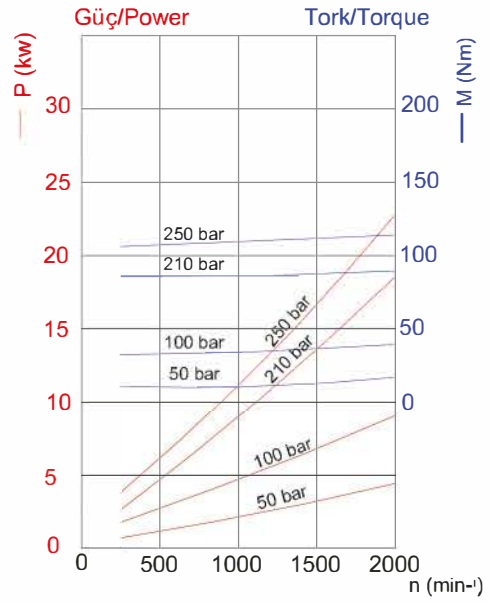

35 LT

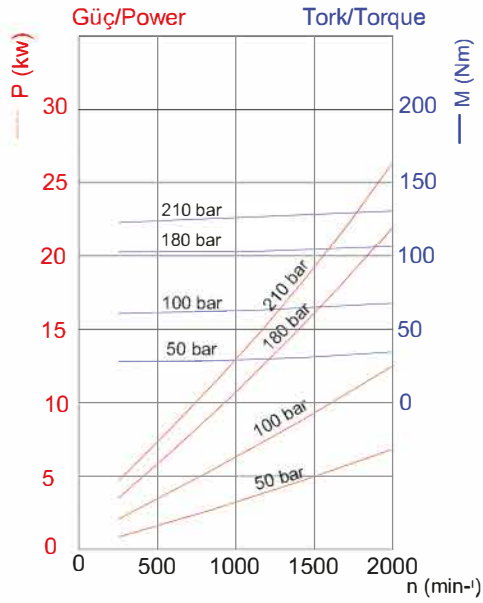

45 LT

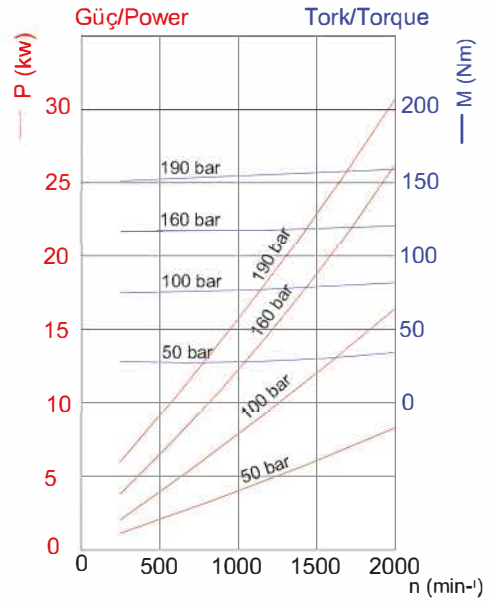





## Pompa Tipi Okuma Diyagramı | Type Reading Diagram

<b>PDCD</b>	-	<b>30</b>	-	<b>065</b>	-	<b>01</b>	-	<b>3</b>	-	<b>1</b>
Çift Dönümlü Dişli Pompa Bi Rotatnal Gear Pumps		30 Serisi Dişli Pompa 30 Series Gear Pumps		Pompa Debisi Displacement		Mil Tipi Shaft Type DIN 5462 ISO		Bağlantı Tipi Mounting holes		Dönüş Yönü Rotation

## Teknik Çizim | Technical Drawing

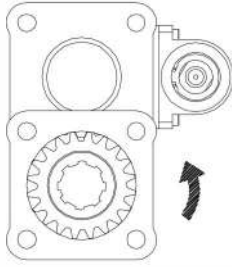

PTO Mili saat yönünde (SAĞ)  
The PTO shaft is CW rotating

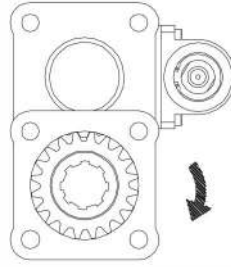

PTO Mili saatin tersi yönünde (SOL)  
The PTO shaft is CCW rotating

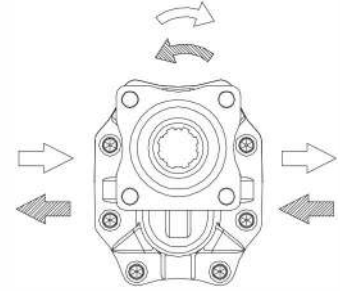

çift yönlü dönüş  
Reversible Rotational

Giriş-Çıkış Rakor yerlerini  
değiştirerek yönünü değiştirebilirsiniz  
You Can Change The Directional Of The Pump  
By Changing The Inlet And Outlet Fitting

## Basınç Tanımı | Pressure Definiton

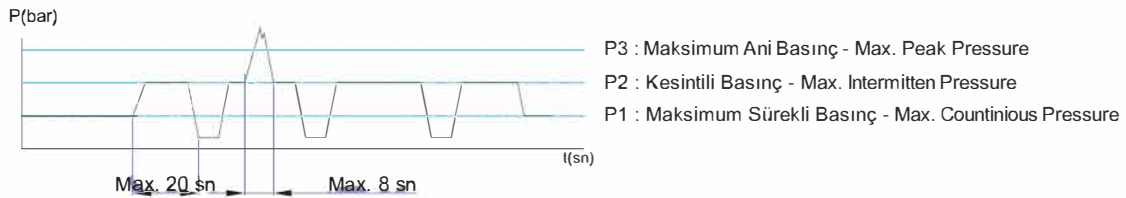

Pompa Tipi Pump Type	Debi Displacement	Max. Sürekli Hız Max. Speed at Continuous Press.	Maksimum Kesik Hız Max. Speed at Intermittent Press.(nmax)	Min Kesik Hız Min. Speed at Intermittent Press.	Max Sürekli Basınç Max. Continuous Pressure (Pnom)	Max. Kesik Basınç Max. Intermittent Pressure (Pmax)	Max. Pik Basınç Max. Peak Pressure (Pmax)
	lt/min	n (min <sup>-1</sup> ) (≤ P1)	n (min <sup>-1</sup> ) (P ≤ 30 bar)	n (min <sup>-1</sup> )	bar	bar	bar
55 lt	55	1700	2000	300	220	240	250
61 lt	61	1700	2000	300	210	230	240
65 lt	65	1700	2000	300	210	230	240
82 lt	82	1500	1800	300	180	210	220



# 30 Grubu Çift Dönürlü Dişli Pompa 30 Group Bi-Rotational Gear Pumps

ISO

ürün kodu | product code

PDCD300 55 | 65 | 82 10133

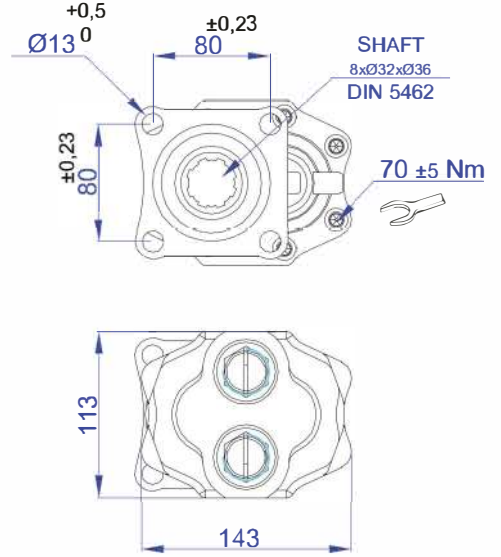
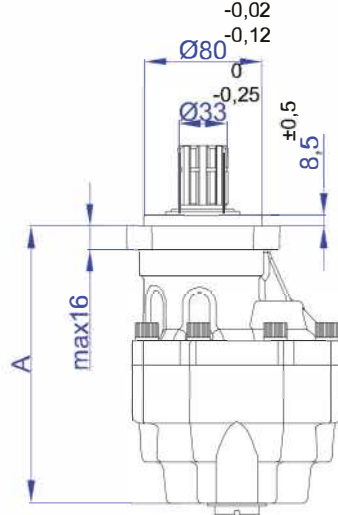
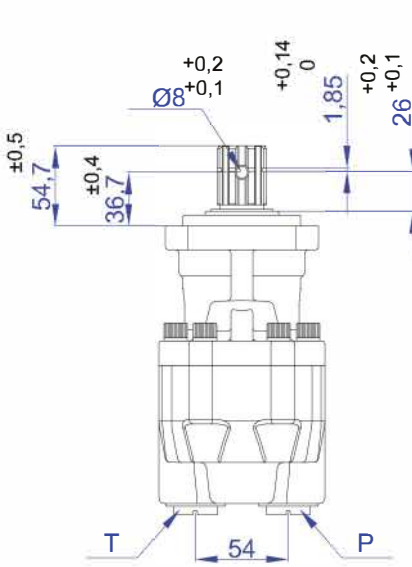
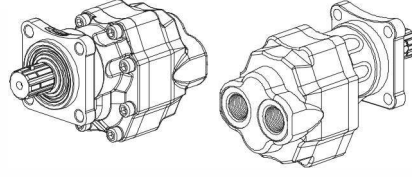

UNI

ürün kodu | product code

PDCD300 55 | 65 | 82 10013

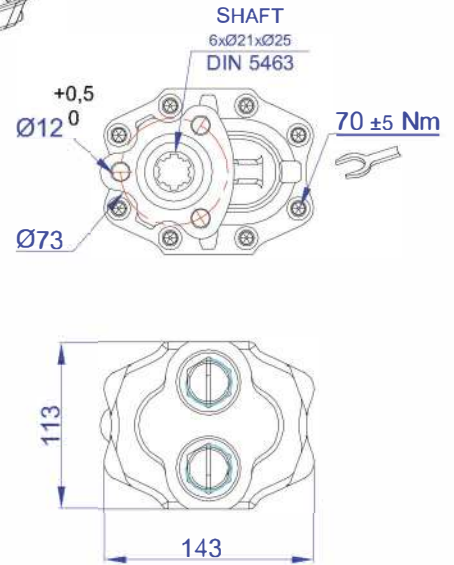
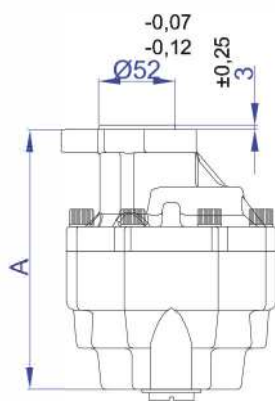
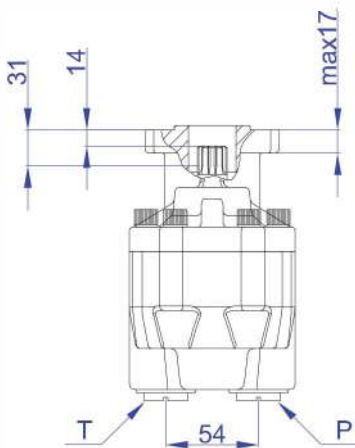
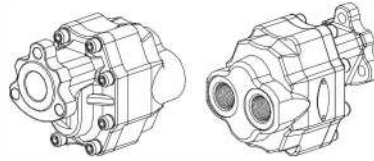

Pompa Tipi Pump Type	Pompa Kodu Pump Code	kapak bağlantı tipi cover mounting tipping	A (mm)	T (mm)	P (mm)	Ağırlık (kg) Weight
55 lt	PDCD3005510133	ISO	182,5	G 1"	G 1"	11
	PDCD3005510013	UNI	169,5	G 1"	G 1"	9,3
65 lt	PDCD3006510133	ISO	189,5	G 1"	G 1"	11,5
	PDCD3006510013	UNI	176,5	G 1"	G 1"	9,7
82 lt	PDCD3008210133	ISO	201,5	G 1"	G 1"	12,2
	PDCD3008210013	UNI	188,5	G 1"	G 1"	10,3

# 30 Grubu Çift Dönümlü Dişli Pompa 30 Group Bi-Rotational Gear Pumps

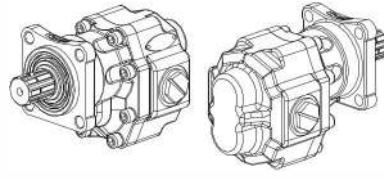

ürün kodu | product code

PDCD300 55 65 82 20133

ISO

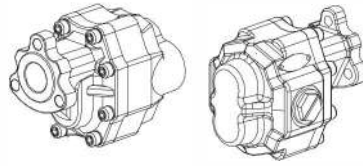
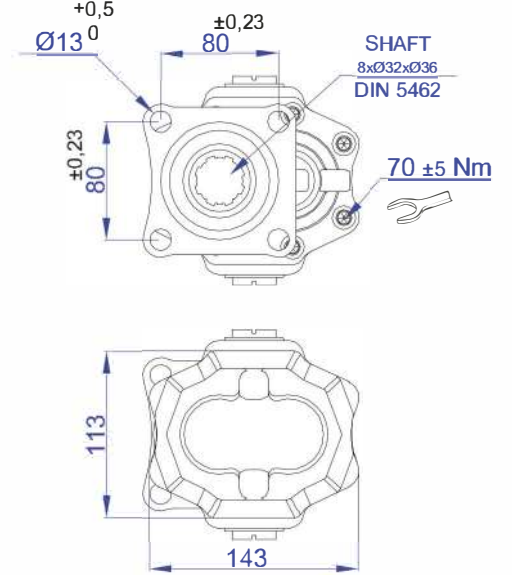
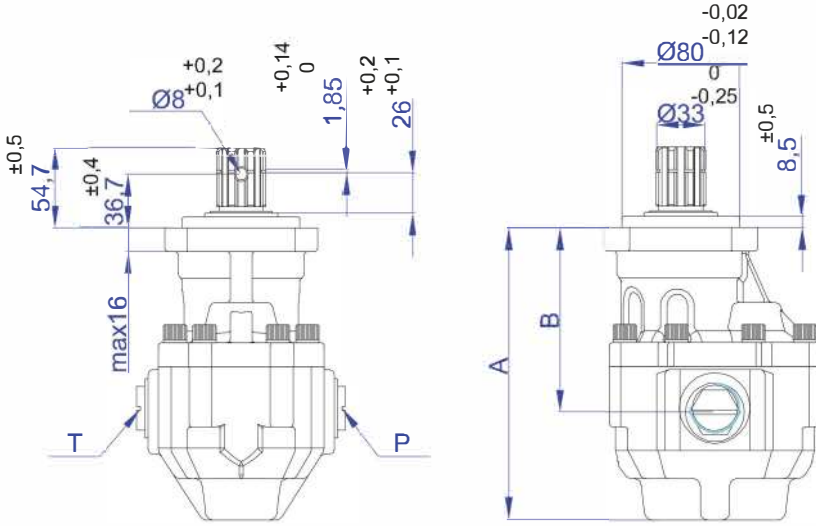

ürün kodu | product code

PDCD300 55 65 82 20013

UNI

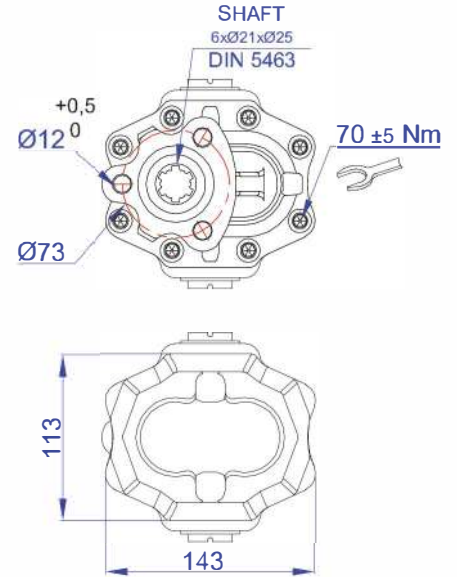
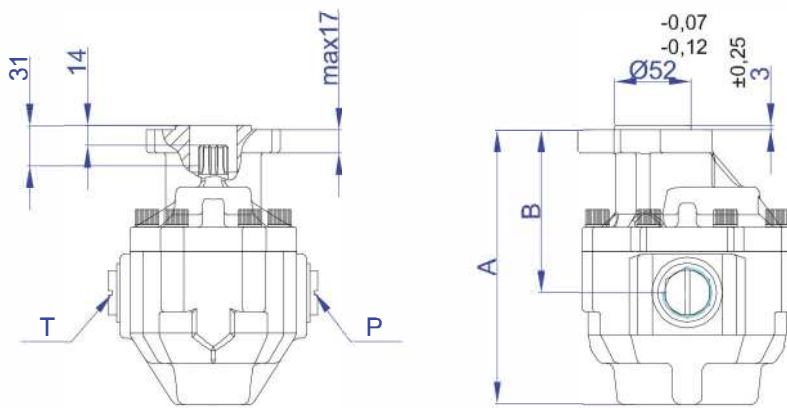

Pompa Tipi Pump Type	Pompa Kodu Pump Code	kapak bağlantı tipi cover mounting tipping	A (mm)	B (mm)	T (mm)	P (mm)	Ağırlık (kg) Weight
55 lt	PDCD3005520133	ISO	182,5	123,5	G 1"	G 1"	11
	PDCD3005520013	UNI	169,5	110,5			9,3
65 lt	PDCD3006520133	ISO	189,5	126,5	G 1"	G 1"	11,5
	PDCD3006520013	UNI	176,5	113,5			9,7
82 lt	PDCD3008220133	ISO	199,5	125	G 1"	G 1"	12,3
	PDCD3008220013	UNI	186,5	112			10,4





# 30 Grubu Çift Dönürlü Dişli Pompa 30 Group Bi-Rotational Gear Pumps

ISO

ürün kodu | product code

PDCD300 82 0133

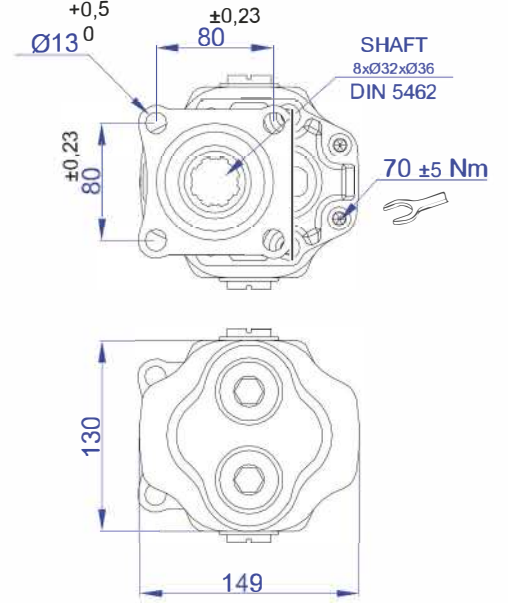
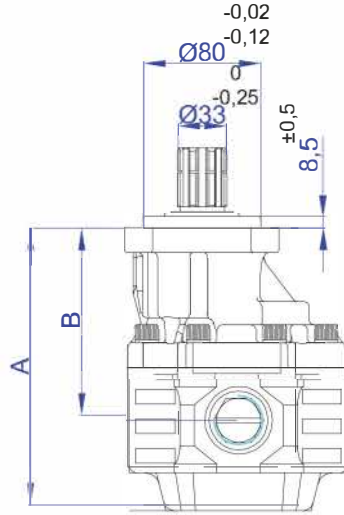
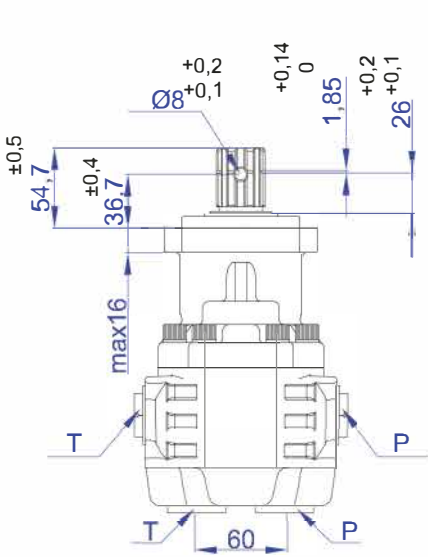
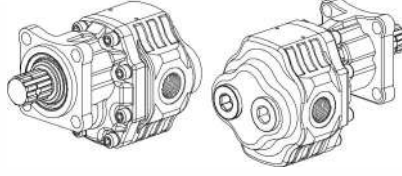

UNI

ürün kodu | product code

PDCD300 82 0013

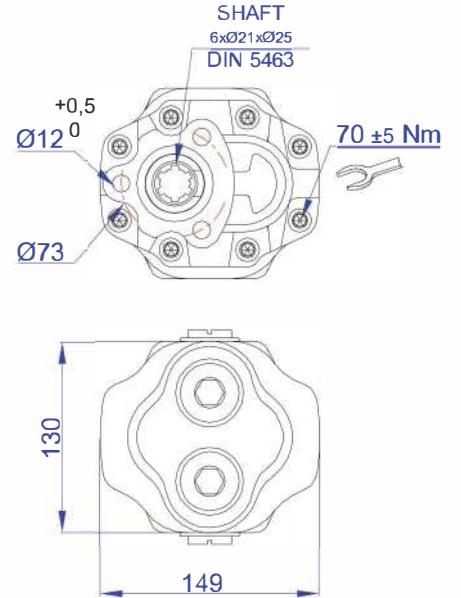
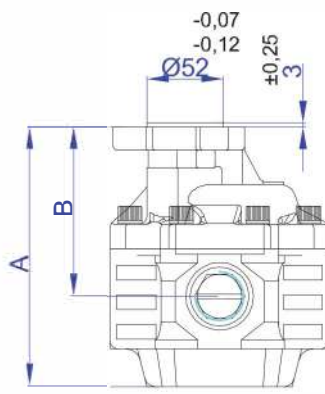
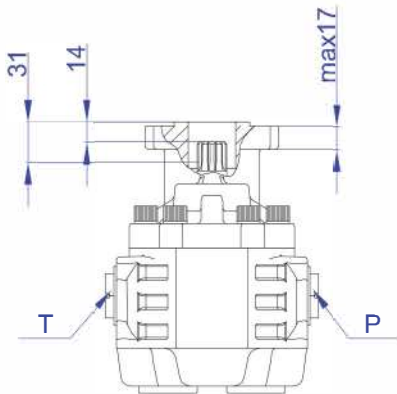
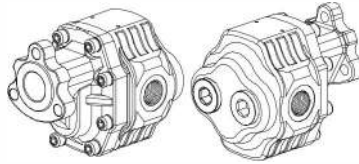

Pompa Tipi Pump Type	Pompa Kodu Pump Code	kapak bağlantı tipi cover mounting tipping	A (mm)	B(mm)	T (mm)	P (mm)	Ağırlık (kg) Weight
82 lt	PDCD300820133	ISO	202	135	G 1"	G 1"	15
	PDCD300820013	UNI	189,5	122,5			13

# 30 Grubu Tek Dönümlü Dişli Pompa 30 Group Single-Rotational Gear Pumps



ISO  
CW

ürün kodu | product code

PDTD300 61 82 0131

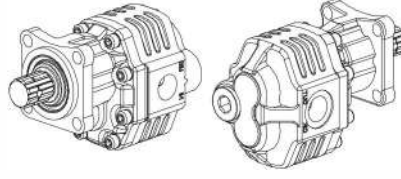

ürün kodu | product code

PDTD300 61 82 0132

ISO  
CCW

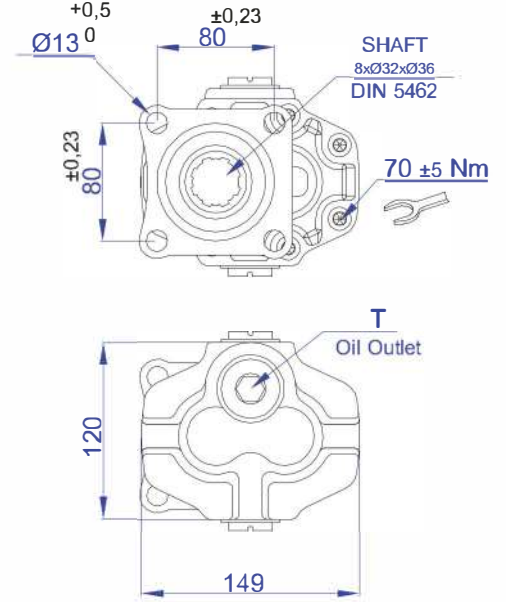
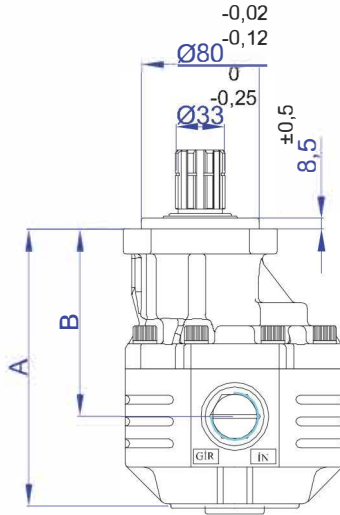
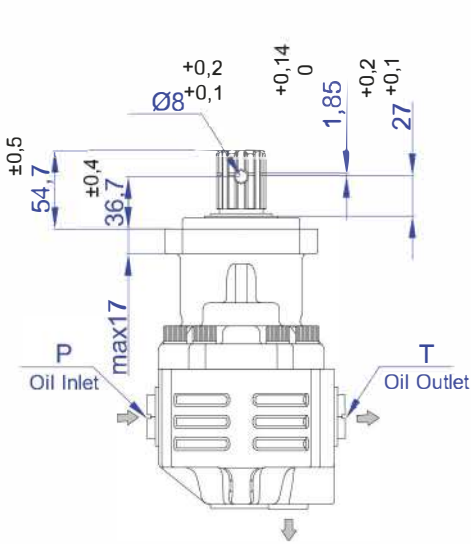

UNI  
CW

ürün kodu | product code

PDTD300 61 82 0011

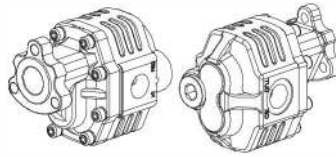

ürün kodu | product code

PDTD300 61 82 0012

UNI  
CCW

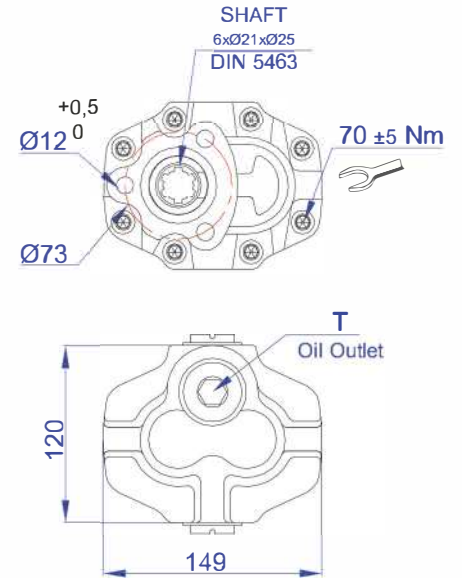
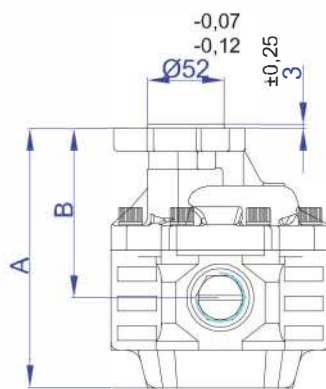
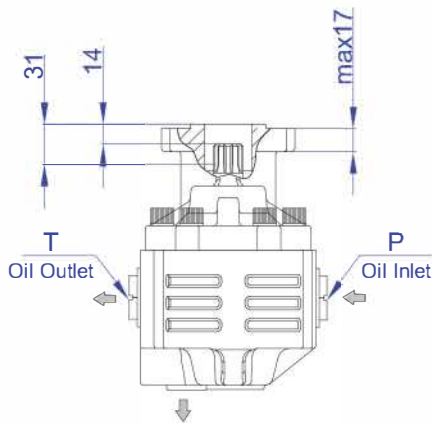

Pompa Tipi Pump Type	Pompa Kodu Pump Code	kapak bağlantı tipi cover mounting tipping	A (mm)	B(mm)	T (mm)	P (mm)	Ağırlık (kg) Weight
61 lt	PDTD300610131/32	ISO	191,5	129			13
	PDTD300610011/12	UNI	177,5	115	G 1"	G 1"	10,5
82 lt	PDTD300820131/32	ISO	204,5	135,5			14,5
	PDTD300820011/12	UNI	190,5	121,5	G 1"	G1 1/4"	12



# 30 Grubu Dişli Pompa 30 Group Gear Pumps

55 LT

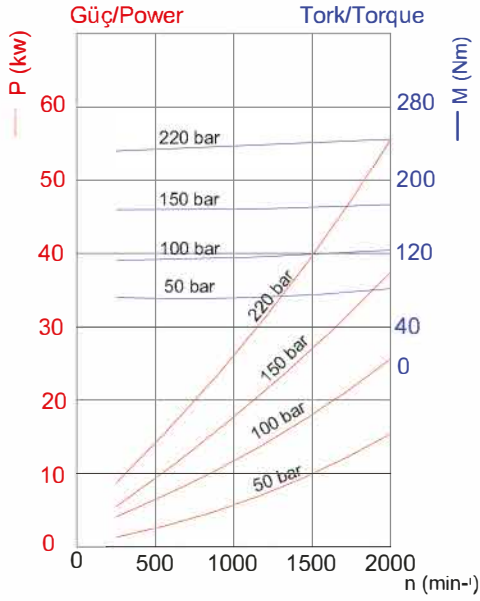

61 LT

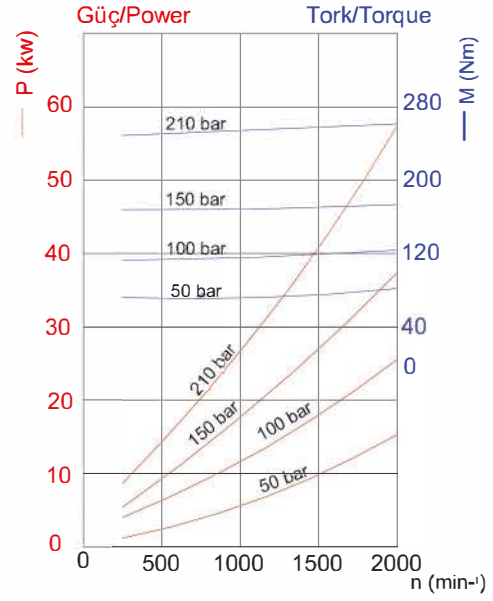

65 LT

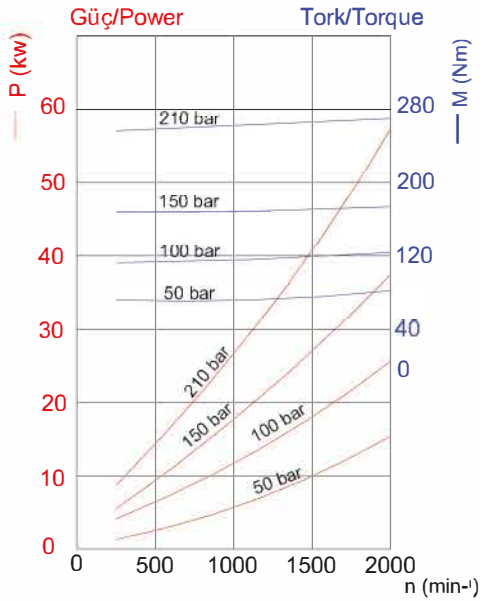

82 LT

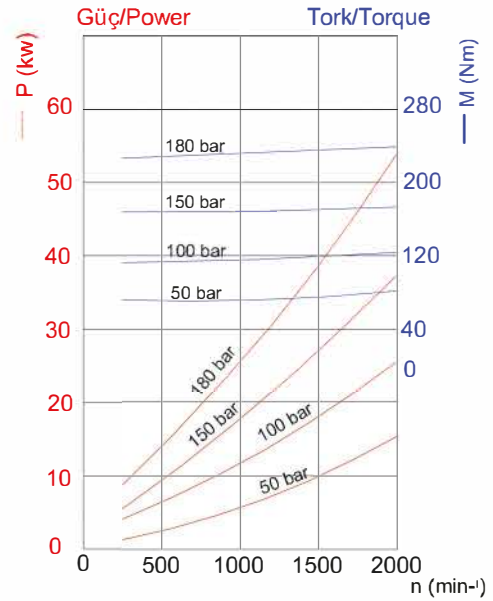

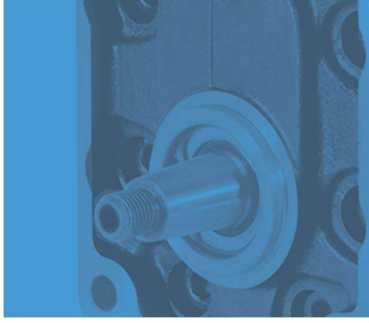

Pompa Tipi Okuma Diyagramı | **Type Reading Diagram**

**PDTDK**

-

**30**

-

**043**

-

**04**

-

**5**

-

**1**

K Serisi Dişli Pompa  
K Series Gear Pumps

30 Serisi Dişli Pompa  
30 Series Gear Pumps

Pompa Debişi  
Displacement

Mil Tipi  
Shaft Type

Bağlantı Tipi  
Mounting holes

Dönüş Yönü  
Rotation

CW

ürün kodu | **product code**

**PDTDK300** **43** **51** **0451**

ürün kodu | **product code**

**PDTDK300** **43** **51** **0452**

CCW

Teknik Çizim | **Technical Drawing**

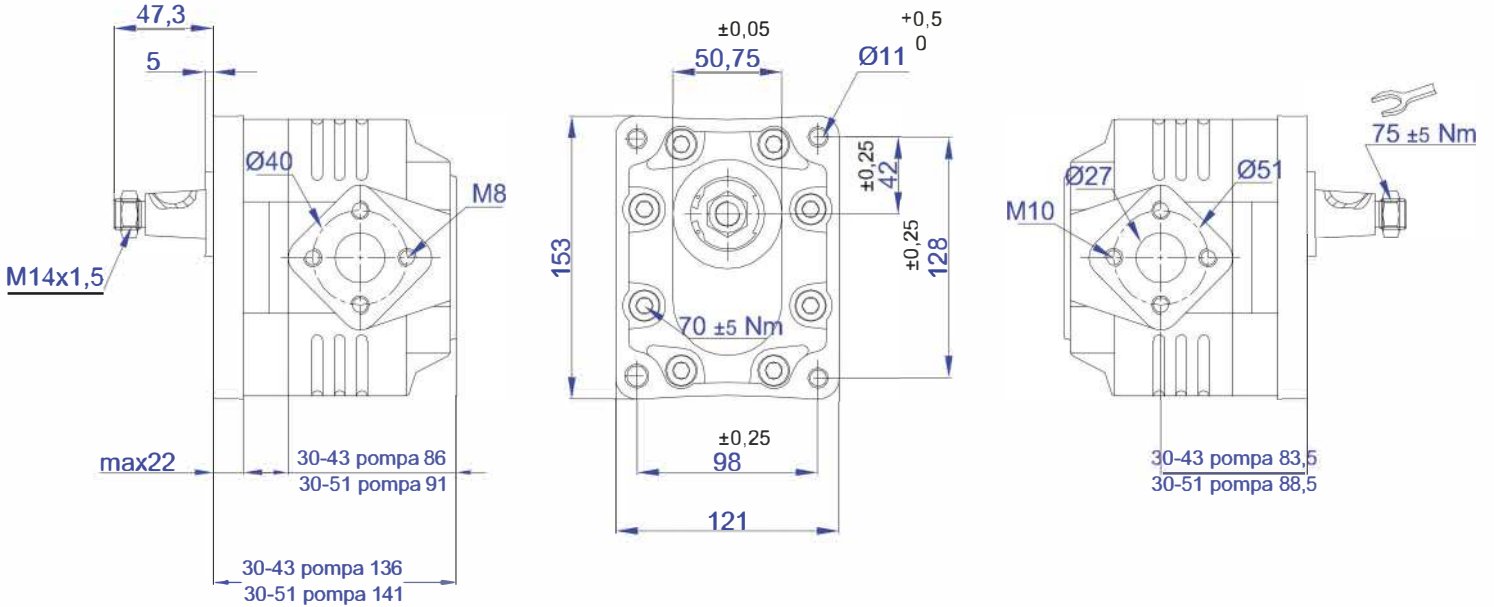

Pompa Tipi Pump Type	Debi Displacement	Max. Sürekli Hız Max. Speed at Continuous Press.	Maksimum Kesik Hız Max. Speed at Intermittent Press. (nmax)	Min Kesik Hız Min. Speed at Intermittent Press.	Max Sürekli Basınç Max. Continuous Pressure (Pnom)	Max. Kesik Basınç Max. Intermittent Pressure (Pmax)	Max. Pik Basınç Max. Peak Pressure (Pmax)
	lt/min	n (min <sup>-1</sup> ) (≤ P1)	n (min <sup>-1</sup> ) (P ≤ 30 bar)	n (min <sup>-1</sup> )	bar	bar	bar
43 lt	43	2000	2500	300	240	260	270
51 lt	51	1800	2200	300	220	240	250





# 35 Grubu Çift Dönüslü Dişli Pompa 35 Group Bi-Rotational Gear Pumps



## Pompa Tipi Okuma Diyagramı | Type Reading Diagram

<b>PDCD</b>	-	<b>35</b>	-	<b>090</b>	-	<b>01</b>	-	<b>3</b>	-	<b>3</b>
Çift Dönüslü Dişli Pompa Bi Rotational Gear Pumps		35 Serisi Dişli Pompa 35 Series Gear Pumps		Pompa Debişi Displacement		Mil Tipi Shaft Type DIN 5462 ISO		Bağlantı Tipi Mounting holes		Dönüş Yönü Rotation

## Teknik Çizim | Technical Drawing

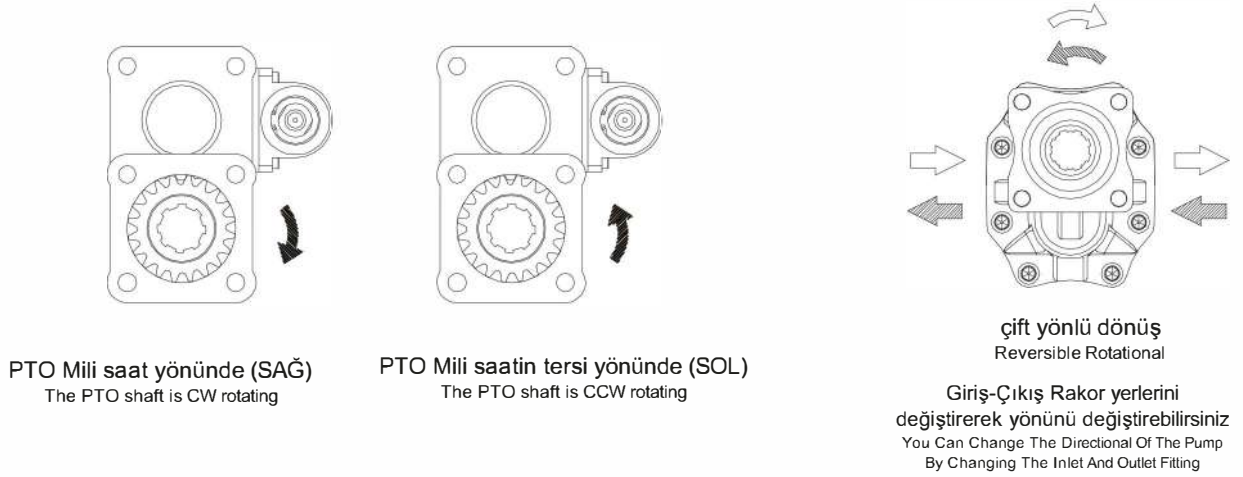

## Basınç Tanımı | Pressure Definiton

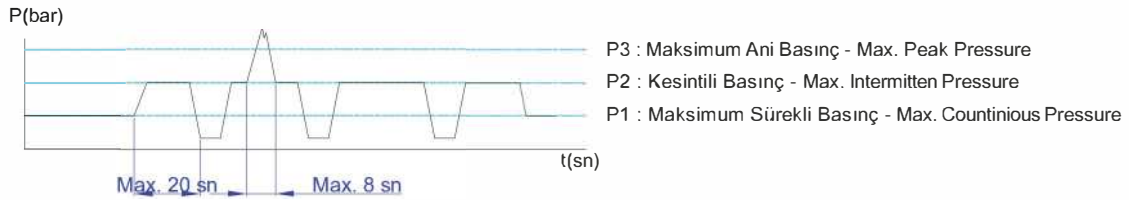

Pompa Tipi Pump Type	Debi Displacement	Max. Sürekli Hız Max. Speed at Continuous Press.	Maksimum Kesik Hız Max. Speed at Intermittent Press.(nmax)	Min Kesik Hız Min. Speed at Intermittent Press.	Max Sürekli Basınç Max. Continuous Pressure (Pnom)	Max. Kesik Basınç Max. Intermittent Pressure (Pmax)	Max. Pik Basınç Max. Peak Pressure (Pmax)
	lt/min	n (min <sup>-1</sup> ) (≤ P1)	n (min <sup>-1</sup> ) (P ≤ 30 bar)	n (min <sup>-1</sup> )	bar	bar	bar
75 lt	75	1500	2000	300	210	230	260
90 lt	90	1500	2000	300	210	230	250
105 lt	105	1400	1900	300	200	220	240
125 lt	125	1400	1900	300	200	210	230

# 35 Grubu Çift Dönürlü Dişli Pompa 35 Group Bi-Rotational Gear Pumps



ürün kodu | product code  
PDCD35 075 | 090 | 105 | 125 0133

ISO

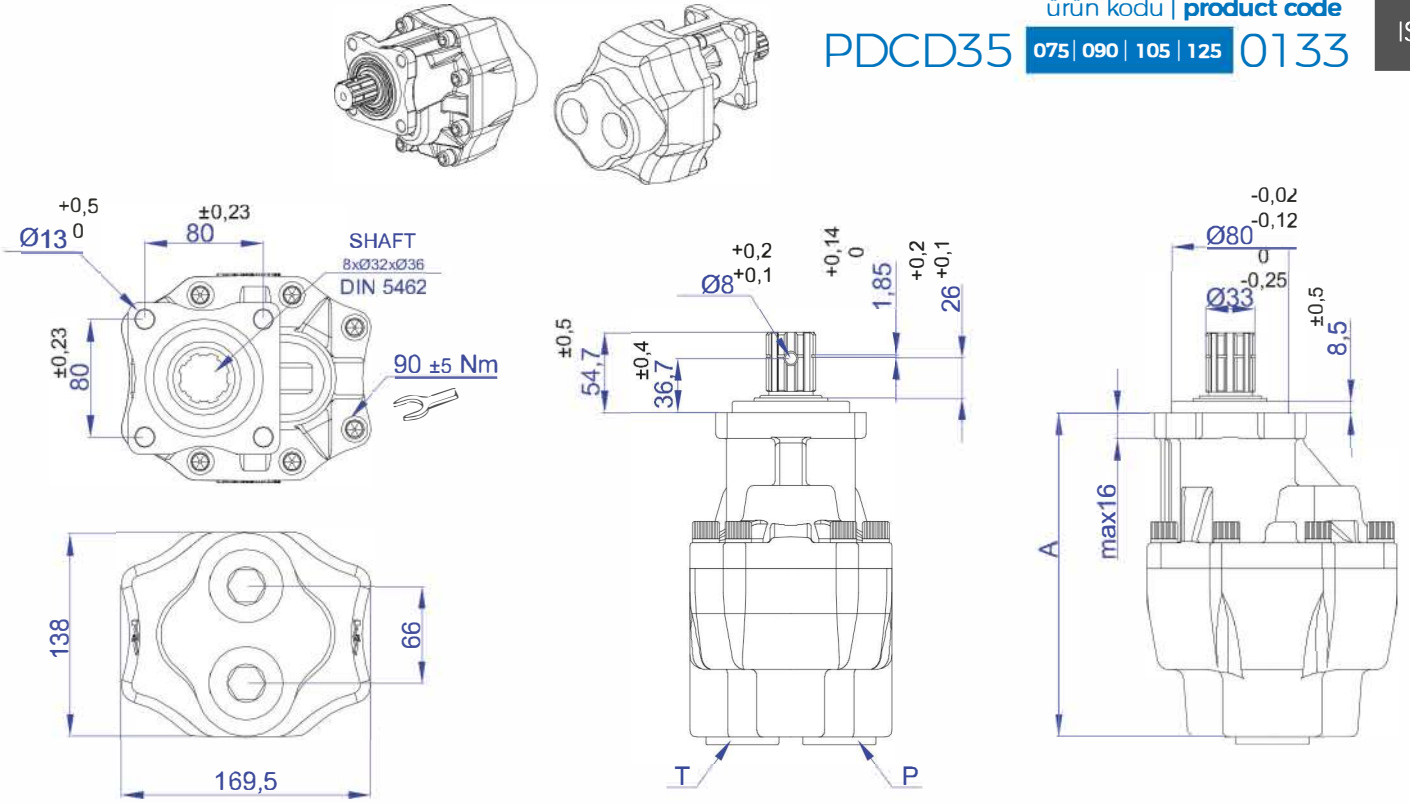

ürün kodu | product code  
PDCD35 075 | 090 | 105 | 125 0013

UNI

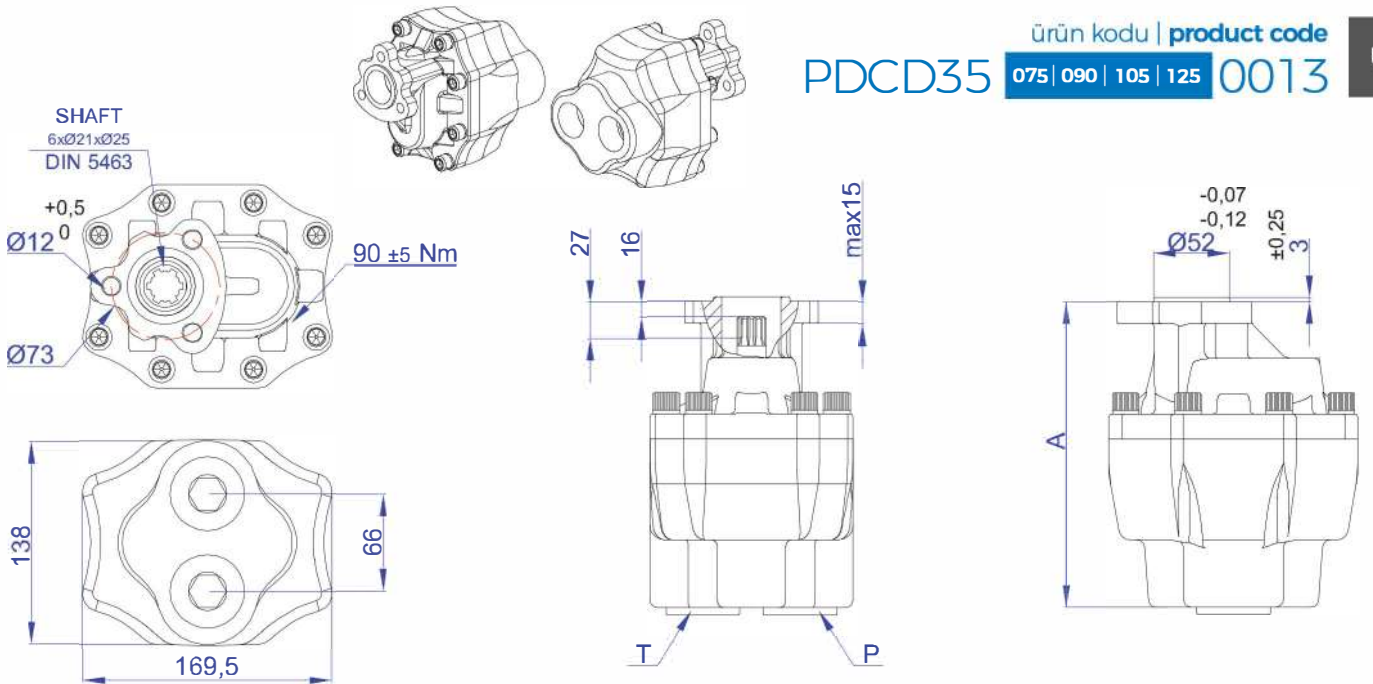

Pompa Tipi Pump Type	Pompa Kodu Pump Code	kapak bağlantı tipi cover mounting tipping	A (mm)	T (mm)	P (mm)	Ağırlık (kg) Weight
75 lt	PDCD350750133	ISO	201	G1 1/4"	G1 1/4"	16,7
	PDCD350750013	UNI	189	G1 1/4"	G1 1/4"	16,5
90 lt	PDCD350900133	ISO	208,5	G1 1/4"	G1 1/4"	17,5
	PDCD350900013	UNI	196,5	G1 1/4"	G1 1/4"	17
105 lt	PDCD351050133	ISO	218	G1 1/4"	G1 1/4"	18,3
	PDCD351050013	UNI	206	G1 1/4"	G1 1/4"	17,8
125 lt	PDCD351250133	ISO	223	G1 1/4"	G1 1/4"	19,4
	PDCD351250013	UNI	211	G1 1/4"	G1 1/4"	19



# 35 Grubu Çift Dönürlü Dişli Pompa 35 Group Bi-Rotational Gear Pumps

075 LT

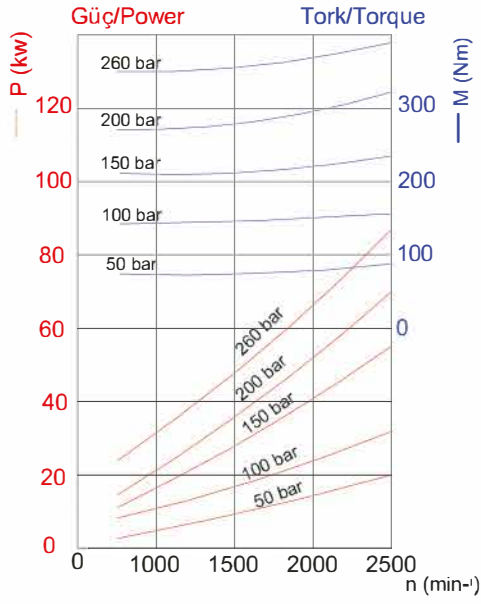

090 LT

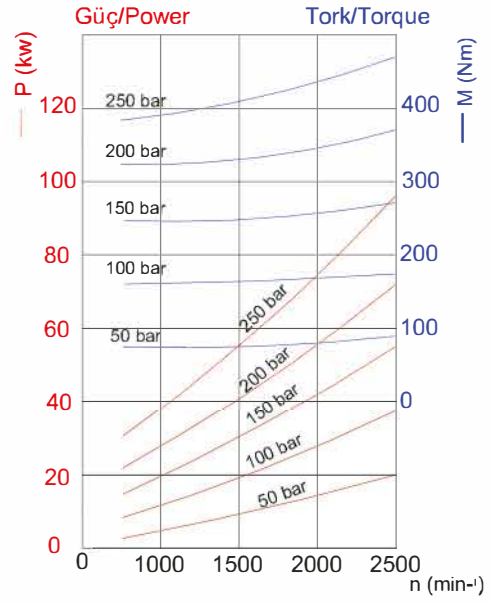

105 LT

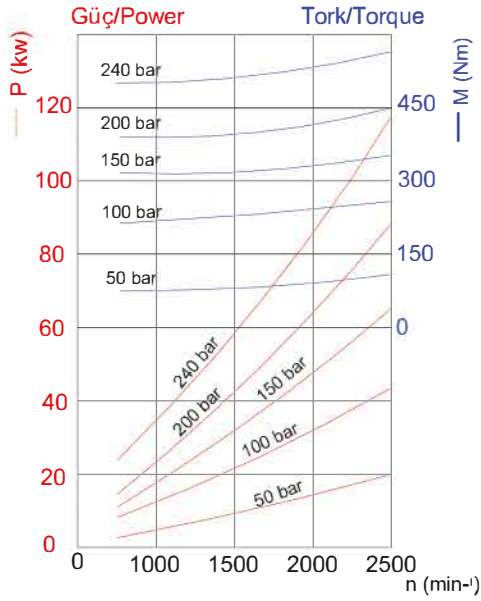

125 LT

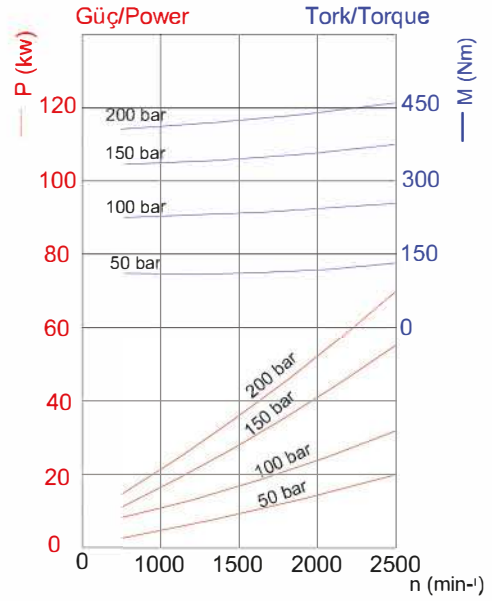

# 40 Grubu Tek Dönümlü Dişli Pompa 40 Group Single-Rotational Gear Pumps

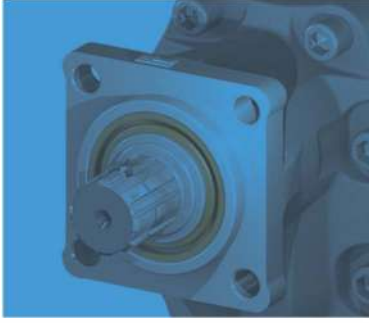

## Pompa Tipi Okuma Diyagramı | Type Reading Diagram

<b>PDTD</b>	-	<b>40</b>	-	<b>087</b>	-	<b>01</b>	-	<b>3</b>	-	<b>1</b>
Tek Dönümlü Dişli Pompa Single Rotational Gear Pumps		40 Serisi Dişli Pompa 40 Series Gear Pumps		Pompa Debisi Displacement		Mil Tipi Shaft Type DIN 5462 ISO		Bağlantı Tipi Mounting holes		Dönüş Yönü Rotation

## Teknik Çizim | Technical Drawing

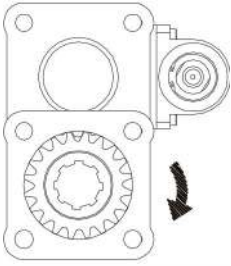

PTO Mili saat yönünde (SAĞ)  
The PTO shaft is CW rotating

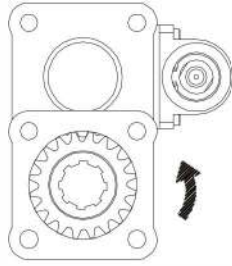

PTO Mili saatin tersi yönünde (SOL)  
The PTO shaft is CCW rotating

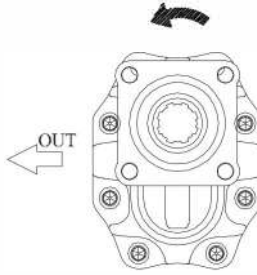

saat yönünün tersi dönüş  
CCW Rotational

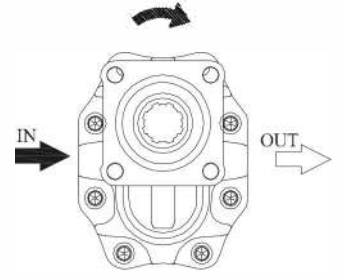

saat yönündeki dönüş  
CW Rotational

## Basınç Tanımı | Pressure Definiton

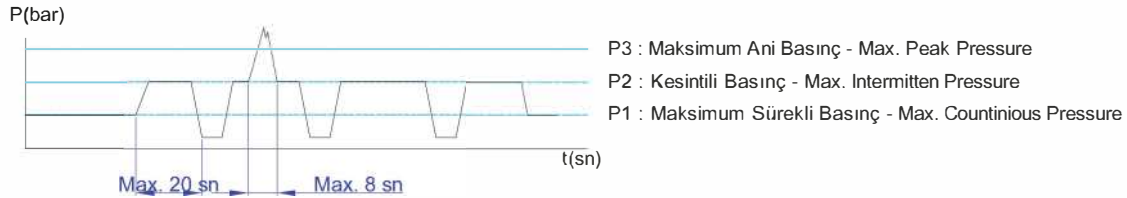

Pompa Tipi Pump Type	Debi Displacement	Max. Sürekli Hız Max. Speed at Continuous Press.	Maksimum Kesik Hız Max. Speed at Intermittent Press.(nmax)	Min Kesik Hız Min. Speed at Intermittent Press.	Max Sürekli Basınç Max. Continuous Pressure (Pnom)	Max. Kesik Basınç Max. Intermittent Pressure (Pmax)	Max. Pik Basınç Max. Peak Pressure (Pmax)
	lt/min	n (min <sup>-1</sup> ) (≤ P1)	n (min <sup>-1</sup> ) (P ≤ 30 bar)	n (min <sup>-1</sup> )	bar	bar	bar
87 lt	87	1700	2000	300	220	240	250
109 lt	109	1700	2000	300	210	230	240
133 lt	133	1700	2000	300	200	220	230
151 lt	151	1600	1900	300	170	195	210





# 40 Grubu Tek Dönümlü Dişli Pompa

## 40 Group Single-Rotational Gear Pumps



087 LT

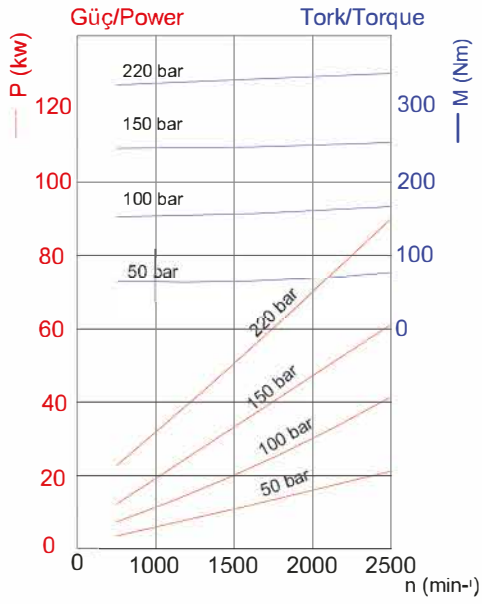

109 LT

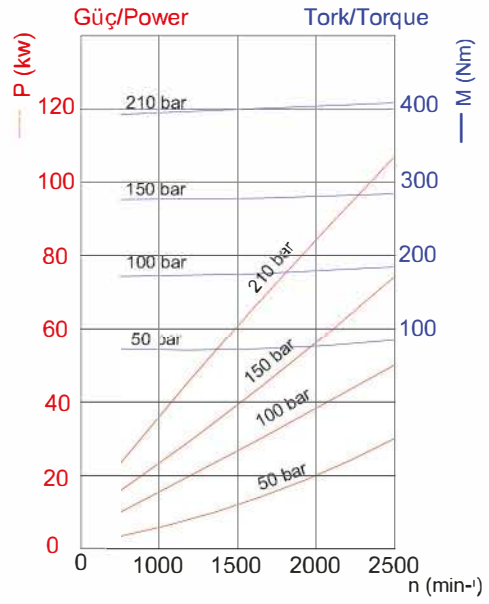

133 LT

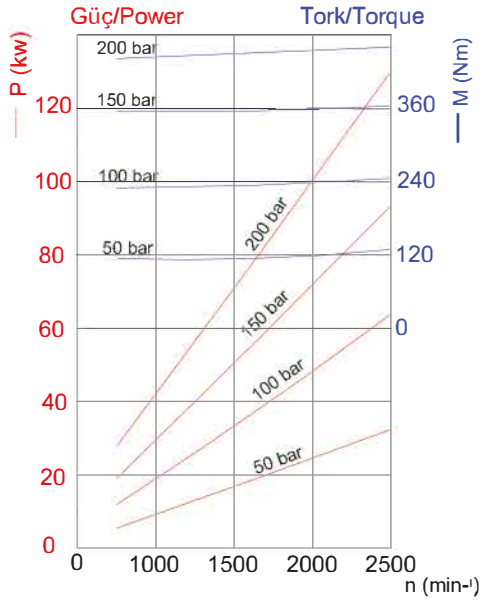

151 LT

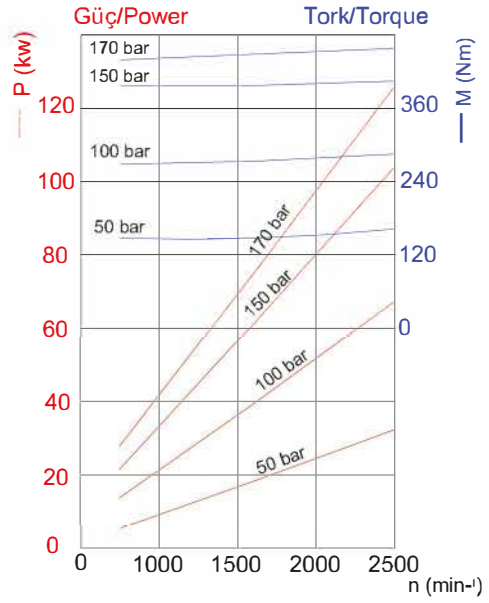



# 40 Grubu Tandem Dişli Pompa 40 Group Tandem Gear Pumps

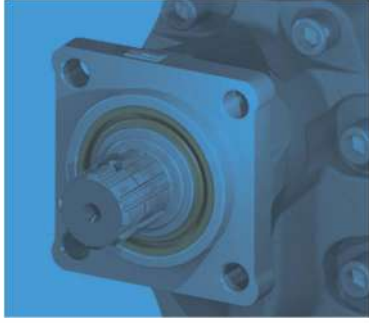

## Pompa Tipi Okuma Diyagramı | Type Reading Diagram

<b>PDTDT</b>	-	<b>40</b>	-	<b>087</b>	-	<b>01</b>	-	<b>3</b>	-	<b>1</b>
Tandem Dişli Pompa Tandem Gear Pumps		40 Serisi Dişli Pompa 40 Series Gear Pumps		Pompa Debisi Displacement		Mil Tipi Shaft Type DIN 5462 ISO		Bağlantı Tipi Mounting holes		Dönüş Yönü Rotation

## Teknik Çizim | Technical Drawing

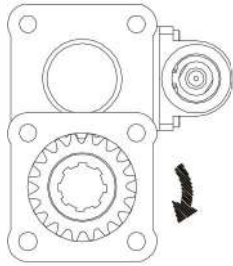

PTO Mili saat yönünde (SAĞ)  
The PTO shaft is CW rotating

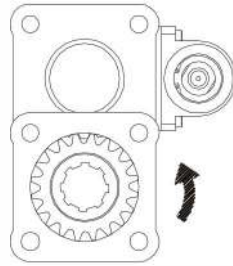

PTO Mili saatin tersi yönünde (SOL)  
The PTO shaft is CCW rotating

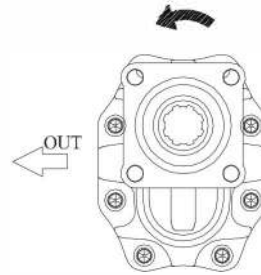

saat yönünün tersi dönüş  
CCW Rotational

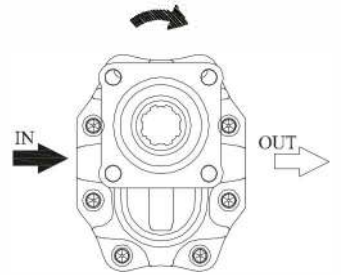

saat yönündeki dönüş  
CW Rotational

## Basınç Tanımı | Pressure Definition

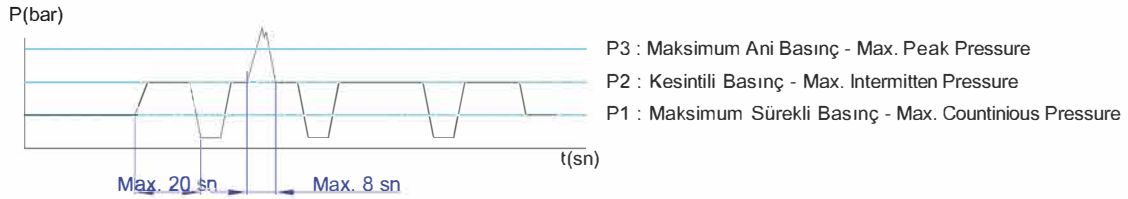

Pompa Tipi Pump Type	Debi Displacement	Max. Sürekli Hız Max. Speed at Continuous Press.	Maksimum Kesik Hız Max. Speed at Intermittent Press.(nmax)	Min Kesik Hız Min. Speed at Intermittent Press.	Max Sürekli Basınç Max. Continuous Pressure (Pnom)	Max. Kesik Basınç Max. Intermittent Pressure (Pmax)	Max. Pik Basınç Max. Peak Pressure (Pmax)
	lt/min	n (min <sup>-1</sup> ) (≤ P1)	n (min <sup>-1</sup> ) (P ≤ 30 bar)	n (min <sup>-1</sup> )	bar	bar	bar
63 lt	63	1700	2200	300	250	270	285
73 lt	73	1700	2200	300	240	260	275
87 lt	87	1700	2000	300	220	240	250
109 lt	109	1700	2000	300	210	230	240
133 lt	133	1700	2000	300	200	220	230

# 40 Crubu Tandem Dişli Pompa 40 Group Tandem Gear Pumps

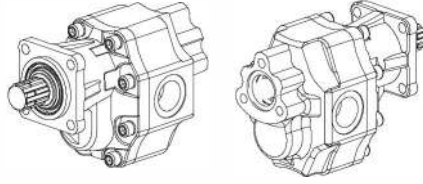

ürün kodu | product code

PDTDT40 063 | 073 | 087 | 109 | 133 0131

PDTDT40 063 | 073 | 087 | 109 | 133 0132

ISO  
CW

CCW

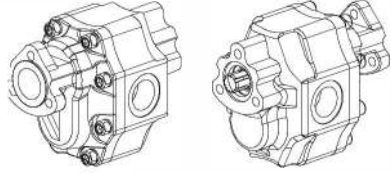
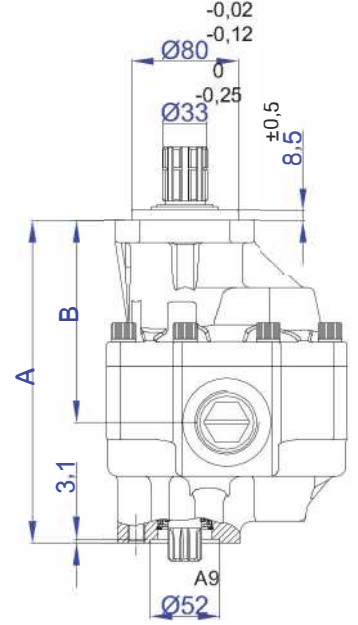
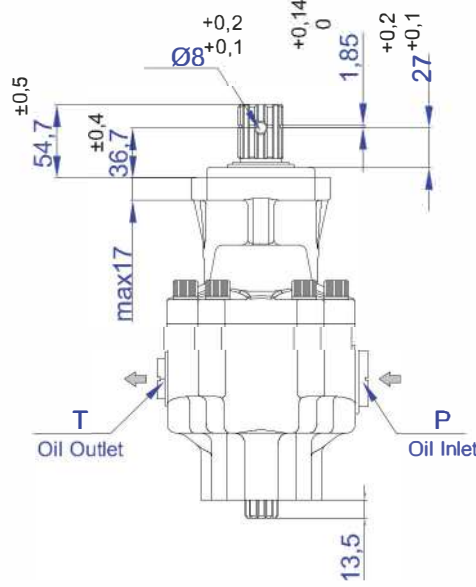
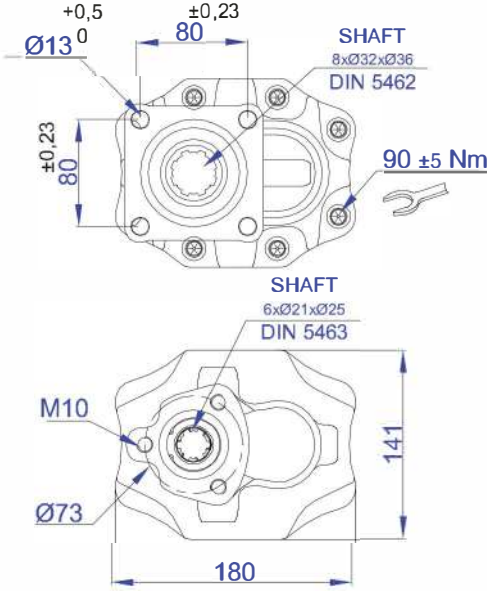

ürün kodu | product code

PDTDT40 063 | 073 | 087 | 109 | 133 0011

PDTDT40 063 | 073 | 087 | 109 | 133 0012

UNI  
CW

CCW

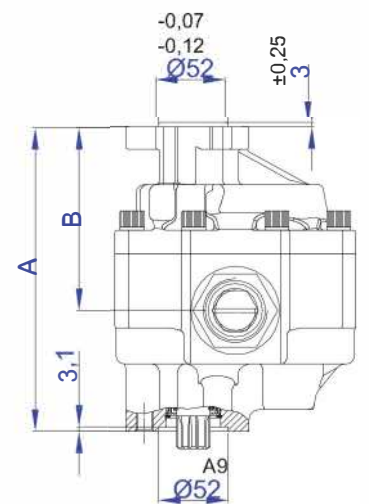
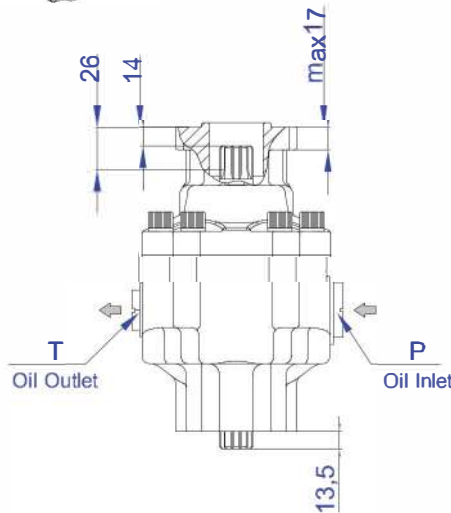
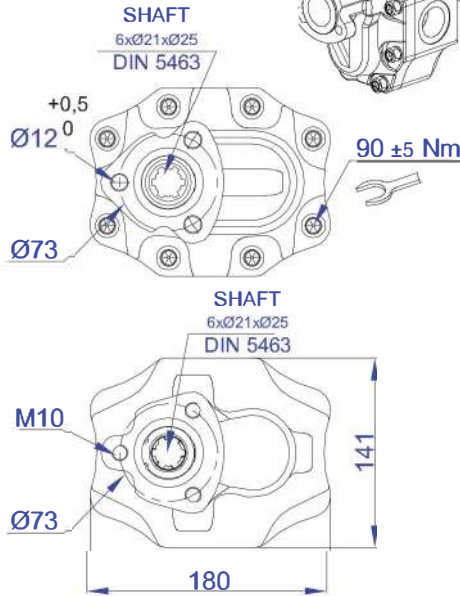

Pompa Tipi Pump Type	Pompa Kodu Pump Code	kapak bağlantı tipi cover mounting tipping	A (mm)	B (mm)	T (mm)	P (mm)	Ağırlık (kg) Weight
63 lt	PDTDT400630131/32	ISO	214,5	133,5	G 1"	G 1"	18,1
	PDTDT400630011/12	UNI	201,5	120,5	G 1"	G 1"	16,1
73 lt	PDTDT400730131/32	ISO	218,5	137,5	G 1"	G1 1/4"	18,4
	PDTDT400730011/12	UNI	205,5	124,5	G 1"	G1 1/4"	16,4
87 lt	PDTDT400870131/32	ISO	223,5	142,5	G 1"	G1 1/4"	19,1
	PDTDT400870011/12	UNI	210,5	129,5	G 1"	G1 1/4"	17,1
109 lt	PDTDT401090131/32	ISO	231,5	146,5	G 1"	G1 1/4"	20,1
	PDTDT401090011/12	UNI	218,5	133,5	G 1"	G1 1/4"	18,1
133 lt	PDTDT401330131/32	ISO	240,5	150,5	G 1"	G1 1/2"	21,1
	PDTDT401330011/12	UNI	227,5	137,5	G 1"	G1 1/2"	19,3





# 40 Grubu Tandem Dişli Pompa 40 Group Tandem Gear Pumps

063 LT

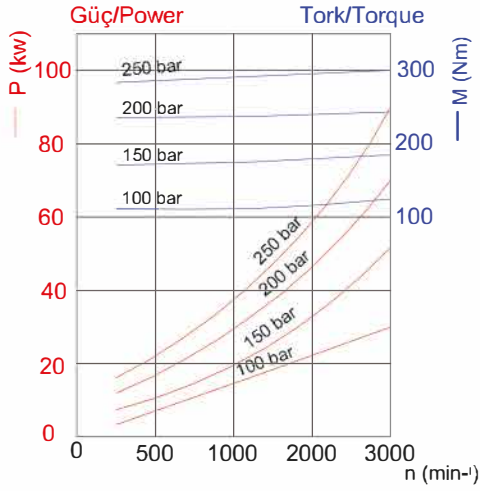

73 LT

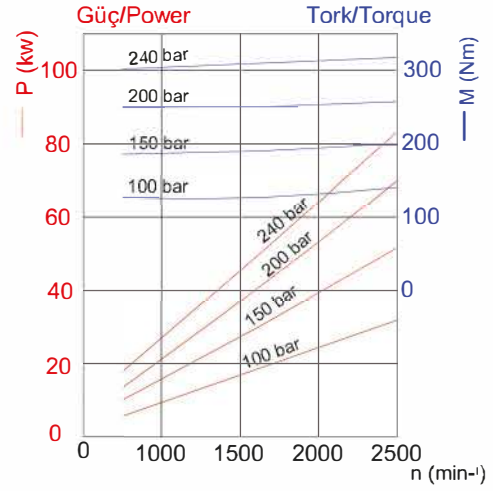

087 LT

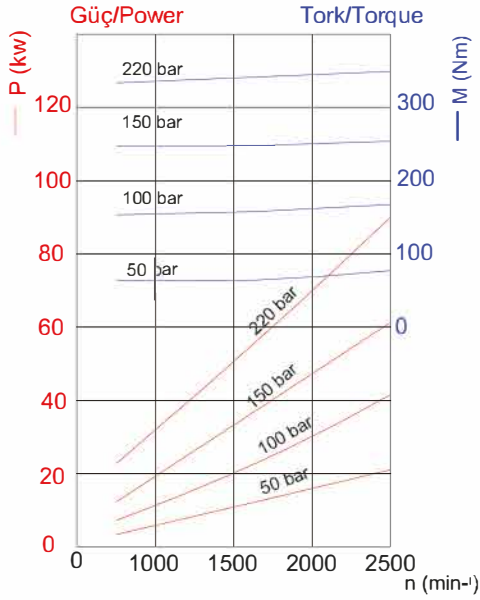

109 LT

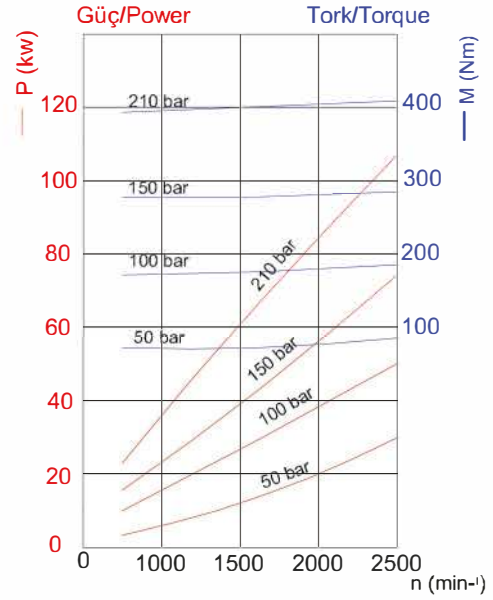

133 LT

